

ROCO MULTI AIR

Operating Manual



1. PREFACE	3
Explanations to symbols	3
Spare part overview exploded diagram	4
Spare part overview article numbers	6
Dimensions	7
Amount of fuel	7
Packaging	7
Electrical connection	7
2. IMPORTANT INFORMATION	8
General warning and safety information	8
Safety distances	8
Prior to set up	9
The correct chimney connection	9
3. BRIEF INFORMATION ON FUEL - PELLETS	10
What are pellets?	10
Wood pellet specification according to ENplus – A1	10
Pellet storage	10
4. TECHNOLOGY AND SAFETY FUNCTIONS	11
Operating comfort	11
Top efficiency - lowest emissions	11
Pressure monitoring	11
Overheating	11
Low-temperature shutdown	11
Electrical excess current protection	11
Component monitoring	11
Power failure (during heating)	11
Power failure (during the initial stage)	11
5. INSTALLING THE STOVE	12
General information	12
Combustion air	12
Feeding in external combustion air	12
Convection air conduction	12
6. ASSEMBLY/DISMANTLING STONE AND OPTIONS	13
Dismantling stone	13
7. INTERNAL CONTROLS – TOUCH-DISPLAY	15
Basics	15
Operation	15
Input possibilities	15
Displays	15
Putting into operation	16
First steps	16
HOME - main menu	17
Main menu levels	17
MODE - mode selection	17
SETUP – settings	18
Heating time programme	18
INFO - main menu	19
INFO – inputs	19
INFO – outputs	19
INFO – parameters	19
Screen saver	20
Additional information	20

8. COMFORT OPTIONS	21
RIKA room sensor/RIKA radio room sensor	21
RIKA GSM Control	21
RIKA interface for various options	21
External room thermostat	21
External connection cable bridge	21
9. MODES	22
Pellet operation manual/automatic/comfort	22
Convection fan control Manual / Automatic	22
Pellet container refilling	22
Emergency operation - heating up without electrical Ignition	22
10. WARNING AND ERROR MESSAGES	23
Warnings	23
Errors	24
11. CLEANING AND MAINTENANCE	25
Basic information	25
Cleaning the fire trough	25
Ampty the ash drawer	25
Cleaning the door glass	25
Cleaning flue pipes	26
Cleaning the flame temperature sensor	27
Cleaning the pellet container	27
Checking door seal	27
Checking chimney connection	27
12. PROBLEMS - POSSIBLE SOLUTIONS	28
Problem 1	28
Problem 2	28
Problem 3	28
13. INSTRUCTIONS FOR COMMISSIONING PROTOCOL	29
14. GUARANTEE	31

1. PREFACE

Explanations to symbols



...important
note



...useful
tip



...hex #8
(M5 winding)



...hex #10
(M6 winding)



...allen key #5
(M6 winding)



...manually



...allen key #3
(M4 winding)

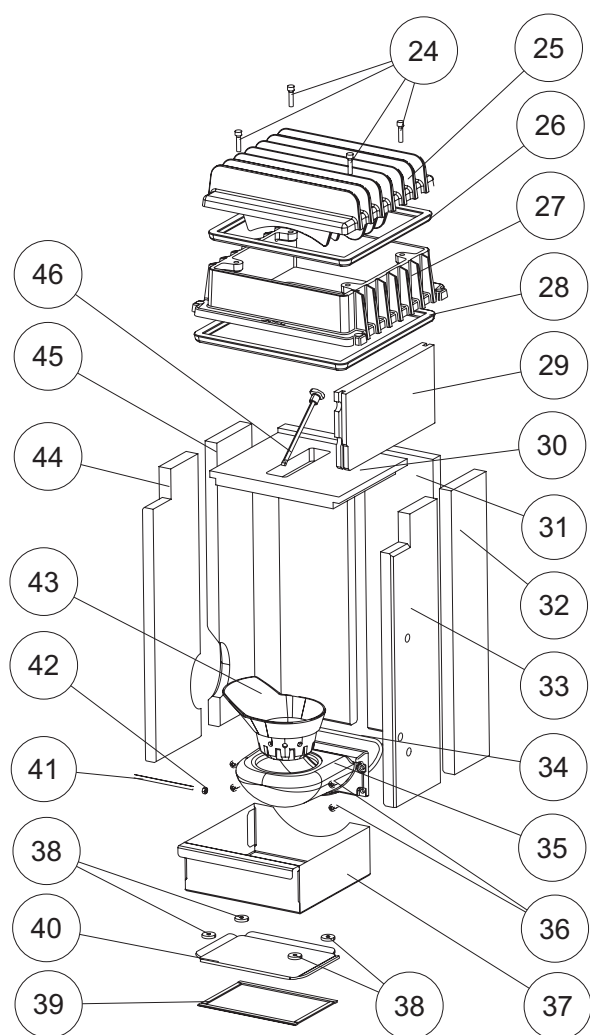
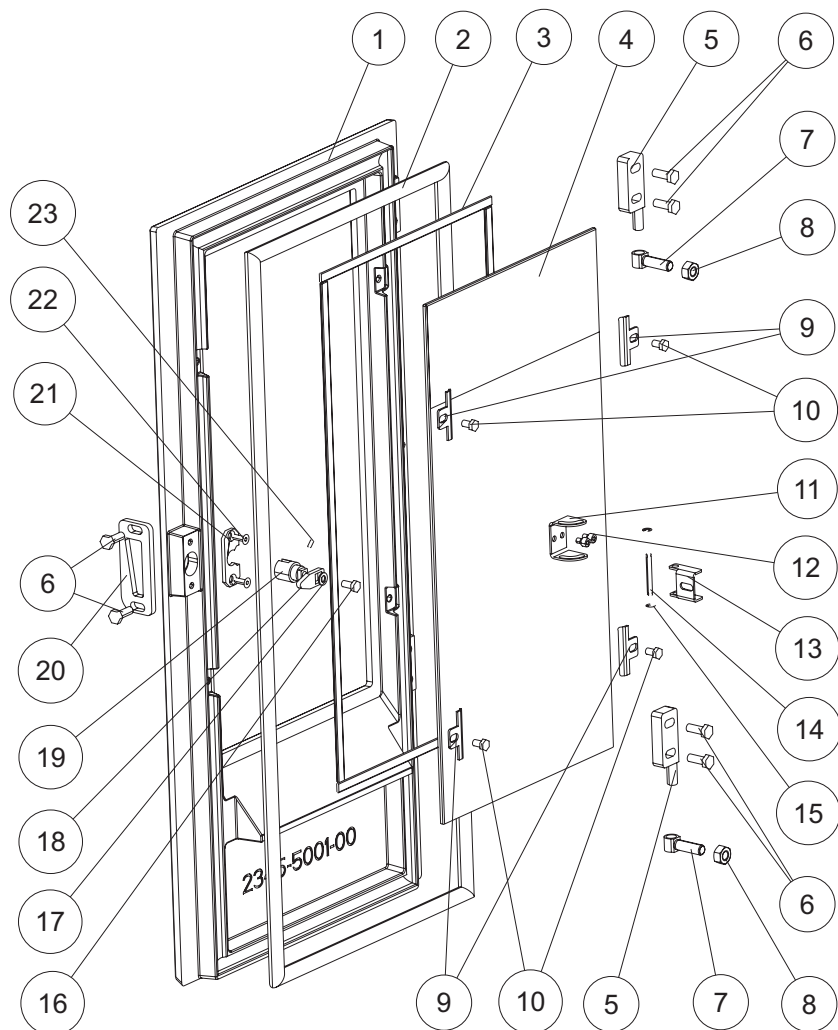

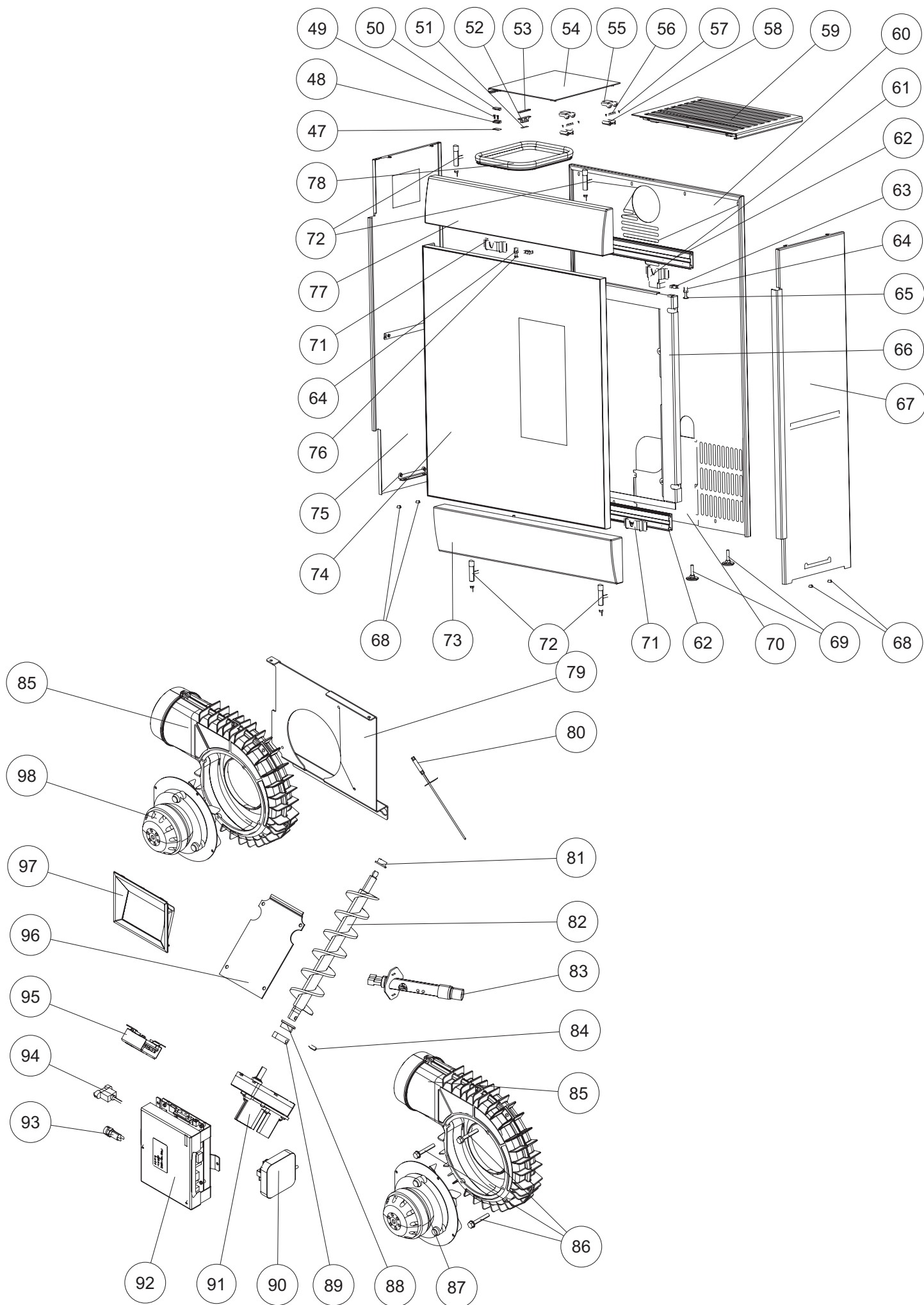

Spare part overview article numbers

#	Art.Nr.:	Description
1	Z34847	combustion chamber door black
2	N100485	Round sealing strip D12
3	N103693	culimeta flat packing black 8x2
4	Z34877	door glas (ceramic glass)
5	Z34855	hinge plate
6	N103964	Hexagonal screw M06x16
7*	Z30550	hinge
7**	Z34441	hinge
8*	N108656	Hexagonal nut M08
8**	N105179	Hexagonal nut M10
9	L00475	glass holder
10	N111799	Hexagonal screw M05x08
11	L02221	stop angle
12	N111990	Hexagon socket M04x06
13	L02217	stopper holder
14	Z34854	hinge shaft
15	N110501	shaft securing device
16	N111950	Hexagonal screw M05x10
17	N100170	lining disc
18	L02220	lock tongue
19	Z34857	Locking bolt
20	L02216	closure flap
21	L02219	holder plate
22	N111856	Hexagonal countersunk screw M04x12
23	N111956	allen screw M03x06
24	N111961	Hexagon socket M06x25
25	Z34846	lid
26	N100485	Round sealing strip D12
27	Z35062	distance
28	N100485	Round sealing strip D12
29	Z34872	Flue plate 2
30	Z35095	Flue plate 1
31	Z34870	combustion chamber liner rear
32	Z34868	combustion chamber side rear
33	Z34866	combustion chamber side front
34	N103066	Round sealing strip D06 (Recess)
35	B16310	fire trough holder
36	N111846	Hexagon socket 06x12
37	L02215	ash drawer
38	N111959	milled nut M05
39	N103693	culimeta flat packing black 8x2
40*	Z35059	cleaning cover
40**	B17282	cleaning cover
41	Z35096	pressure Pipes
42	N100141	Hexagonal nut M05
43	Z35060	fire trough
44	Z34867	combustion chamber side front
45	Z34869	combustion chamber side rear left (till nr.: 1314345)
46	B16053	sensor tube
47	L01445	switch distance
48	N111733	Solenoid switch lower part
49	N111842	Hexagon socket M03x10
50	N111732	magnetic switch upper section
51	L01502	Lock washer
52	N110461	double ball catch
53	L01446	Lock washer
54	LB00543	lid metallic
	LB00542	lid black
55	L02243	hinge lid
56	Z34854	hinge shaft
57	N110501	shaft securing device

#	Art.Nr.:	Description
58	L02244	lid stove
59	LB00545	convection cover metallic
	LB00544	convection cover black
60	L02273	rear wall metallic
	L02271	rear wall black
61	L02254	Suspended sheet
62	N111986	telescopic rail
63	N111645	spring plug
64	Z35098	latching bolt
65	N111983	carriage bolt M06x20
66	Z35237	cover
67	LB00549	Right side panel metallic
	LB00548	Right side panel black
68	N111730	grommet
69	N111695	height adjustment screw
70	L02274	cocer rear wall metallic
	L02272	cover rear wall black
71	L02228	Suspended sheet
72	B17016	stone holder
73	Z34879	lower soapstone
	Z35205	lower stone white
	Z35203	lower sandstone
74	B17020	sliding door decor
75	LB00547	Left side panel metallic
	LB00546	Left side panel black
76	N111982	Hexagonal screw M06x18
77	Z34880	upper soapstone
	Z35204	upper stone white
	Z35202	upper sandstone
78	N111731	container seal
79	Z35108	combustion fan cover
80	B16114	Temperature sensor
81	Z35183	Sintered bearing Di10
82	B12301	screw
83	B17014	ceramic ignition
84	N111058	setscrew with ISK and pin
85	B16155	Induced draft fan housing
86	N105627	Hexagonal screw M06x40
87	N111581	induced draught fan motor
88***	Z35182	Plastic bearing
89	Z11915	lock ring conveyer screw
90	N111985	pressure difference guide
91	N111820	Screw motor, stepless
92	B16561	mainboard USB11
93	N110696	fuse 2,5A
94	N111989	USB cable
95	B16030	additional board
96	L01495	lid
97	B16574	touch-Display
98	N112000	Convection fan motor
	B17023	Cabletree
	N111551	silicone Hose
	L00797	motor plate
	Z35018	Cable touch display
	*	(till serial number 1320321)
	**	(from serial number 1320322)

Dimensions

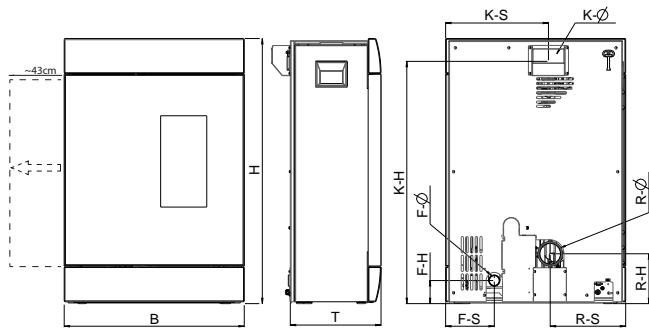

Dimensions

height	[mm]	1138
width	[mm]	773
corpus depth	[mm]	389

Weight

weight without shell	[kg]	198
weight with shell	[kg]	230

Flue pipe connection

R - Ø flue pipe outlet	[mm]	100
RO - H original angle pipe connection height	[cm]	-
RO - T1 original angle pipe total depth	[cm]	-
RO - T2 original angle pipe distance to rear wall	[cm]	-
RO - T3 depth from rear wall to middle of flue pipe	[cm]	-
RO - S original angle pipe side distance	[cm]	-
R - H rear connection height	[cm]	21
R - S rear connection side distance	[cm]	32

Fresh air connection

F - Ø diameter	[mm]	50
F - H connection height	[cm]	10
F - S side distance	[cm]	21
F - H (*) connection height	[cm]	34
F - S (*) side distance	[cm]	28
till serial number (*)		1324556

Convection air connection

K - Ø diameter	[mm]	100
K - H connection height	[cm]	104
K - S side distance	[cm]	44

Amount of fuel

	nominal load	part load
Amount of fuel	~2,2kg*	~0,6kg*
Burn time at full pellet hopper	ca. 17h	ca. 41h

*Practical values may vary depending on pellet quality.

Technical data

heating power range	[kW]	2,7 - 9
room heating capacity (depending on house insulation)	[m³]	50 - 240
fuel consumption	[kg/h]	bis 2,2
pellet container capacity	[kg]	31
electric supply	[V]/[Hz]	230/50
average electrical input	[W]	~ 20
fuse	[A]	2,5 AT
Efficiency	[%]	90,3
CO2	[%]	12,1
CO-emission on 13% O2	[mg/m _N ³]	43
dust emission	[mg/m _N ³]	16
exhaust	[g/s]	5,7
exhaust temperature	[°C]	176
chimney draft requirement	[Pa]	3

Note

Pellet consumption depends on the size of the pellets. The larger the pellet, the slower the feed and vice versa

The owner of small firing systems or the person authorised for the small firing system is to keep the technical documentation and is to submit it to the authorities or the chimney sweep on request.

Note

Please observe the national and European standards as well as local regulations concerning the installation and operation of firing installations!

Packaging

Your first impression is important to us!

The packaging of your new stove provides excellent protection against damage. However damage to the stove and accessories may still occur during transport.

Note

Therefore please check your stove on receipt for damage and completeness! Report any deficiencies to your dealer immediately! Pay particular attention during unpacking that the stone panels remain intact. Scratches to the material can easily occur. Stone panels are excluded from the warrant

The packaging of your new stove is environmentally neutral to a great extent

Tip

The wood used in the packaging has not been surface treated and may therefore be burnt in your stove. The cardboard and film (PE) can be disposed of via the municipal waste collection for recycling

Electrical connection

The stove is supplied with an approx. 2m long connecting cable with a Euro-plug. This cable is to be connected to a 230Volt/50Hz socket. The average electrical power consumption is some 20 Watt in heating operation. And approx. 150 Watt during automatic ignition. The connection cable must be laid so that there is no contact to any sharp edges or hot surfaces of the stove.

2. IMPORTANT INFORMATION

General warning and safety information

Observance of the introductory general warning information is imperative.

- Read the entire manual thoroughly before installing and putting the stove into service. Observe the national provisions and laws as well as the regulations and rules applicable locally.
- RIKA stoves should only be installed in rooms with normal humidity (dry areas according to VDE 0100 Part 200). The furnaces are not splash water protected and may not be installed in wet areas.
- Only approved transport equipment with sufficient load carrying capacity may be used with your heating appliance.
- Your heating appliance is not suitable for use as a ladder or stationary scaffolding.
- The burning of fuel releases heat energy that lead to extensive heating of the stove surfaces, doors, door and operating handles, glass, flue pipes and possibly the front wall. Refrain from touching these parts without appropriate protective clothing or equipment e.g. heat-resistant gloves or means of operation (operating handle).
- Make your children aware of this particular danger and keep them away from the stove during heating.
- Only burn approved heating materials
- The combustion or introduction of highly flammable or explosive materials such as empty spray cans etc. in the combustion chamber and storing them near the stove is strictly prohibited due to the danger of explosion.
- No light or inflammable clothing is to be worn when post-heating.
- Placing non-heat resistant objects on the stove or near it is prohibited.
- Do not place clothing on the stove to dry.
- Stands for drying clothes etc. must be placed at a sufficient distance to the stove – ACUTE DANGER OF FIRE!
- When your stove is burning, the use of highly inflammable and explosive materials in the same or adjacent rooms is prohibited

Note
Waste and liquids may not be burnt in the stove!

Note
To prevent your stove from overheating of the internal components, do never cover the convection fins!

Safety distances

Note

1. To non-combustible objects
 $a > 40 \text{ cm}$ $b > 10 \text{ cm}$
2. To combustible objects and reinforced concrete load-bearing walls
 $a > 80 \text{ cm}$ $b > 20 \text{ cm}$

Tip

please observe a minimum distance of 20 cm behind and sideways the stove for maintenance.

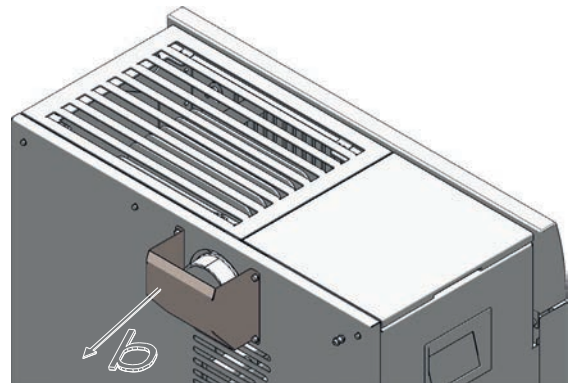
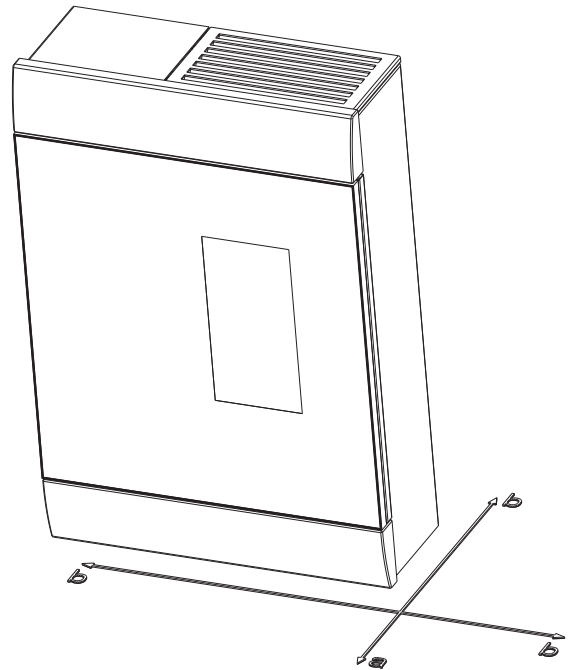

Prior to set up

Floor bearing capacity

Ensure that the substructure is capable of bearing the weight of the stove prior to set-up.

Note

No modifications may be made to the firing installation. This also leads to loss of warranty and guarantee.



Floor protection

A base is required (glass, sheet steel or ceramic) if the floor is combustible (wood, carpet, etc.).

Flue pipe connection

- Flue pipes pose a particular source of hazard regarding gas leaks and fire. Get the advice of an authorised specialist company for the layout and assembly.
- Please observe the corresponding installation guidelines for walls panelled with wood when connecting your flue pipes to the stove,
- Observe the formation of flue gas (atmospheric inversion) and draughts when the weather is unfavourable.
- Infeed of too little combustion air can lead to smoke in the rooms or to flue gas leaks. Hazardous deposits in the stove and chimney may also occur.
- If flue gas escapes, let the fire burn out and check whether all the air inlet openings are free and the flue gas pipes and the stove pipe are clean. If in doubt notify the master chimney sweep since draught malfunctions may be connected to your chimney.
- Only use suitable tools from our range of accessories when handling embers and make sure that no embers fall out of the combustion chamber onto inflammable material.
- Use the heat-resistant gloves supplied to open the doors of your stove.

The correct chimney connection

There are several ways to connect your stove to the chimney, eg:

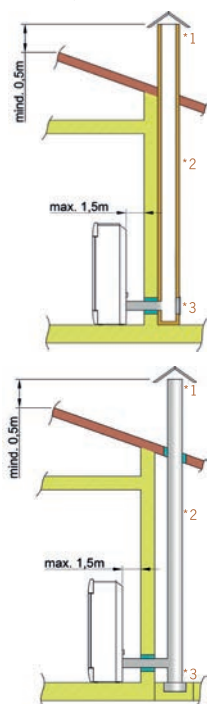

1) wind break, 2) chimney, 3) inspection opening

For the selection of the connection and to ensure a proper connection between the stove and chimney, please read the guide „INSTALLING THE STOVE“ or ask your local chimney sweep.

Stoves type 1 (BA 1):

- Suitable for multiple occupancy. (note the different country regulations)

Note

on ROOM-AIR DEPENDENT and ROOM-AIR INDEPENDENT OPERATION:

Your stove has been tested as a room-air dependent stove according to EN 14785 and does not conform in Germany to the requirements for room-air independent operation. In combination with room-air installations (e.g. controlled ventilation and venting systems (extractors etc.) it must be ensured that the stove and the room air system are monitored and safeguarded mutually (e.g. via a differential pressure controller etc.). The combustion air infeed of approx. 40 m³/h must be ensured. Please observe the respective local regulations and rules in consultation with your master chimney sweep

3. BRIEF INFORMATION ON FUEL - PELLETS

What are pellets?

Wood pellets are a standardised fuel. Every manufacturer must adhere to certain conditions in order to enable flawless, energy-efficient heating. Pellets are made from wooden waste, from sawmills and planning workshops, as well as from residue from forestry operations. These “starting products” are crushed, dried, and pressed into Pellet “Fuel” without any bonding agent.

ENplus – Pellets

This new pellets are a standard sets new benchmarks in the European pellet market. The traceability of pellets is ensured thanks to the use of identification numbers. The pellet manufacturers' production facilities and manufacturing processes are reviewed every year. A quality assurance system ensures the pellets comply with the requirements of the new standard and that the conditions for trouble-free heating are guaranteed

Wood pellet specification according to ENplus – A1

parameter	measure	ENplus-A1
diameter	mm	6 (±1) ²⁾
length	mm	3,15 bis 40 ³⁾
buld density	kg/m ³	≥600
calorific value	MJ/kg	≥16,5
water content	Ma.-%	≤10
fine fraction (<3,15mm)	Ma.-%	≤ 1
mechanical rigidity	Ma.-%	≥97,5 ⁴⁾
ash content	Ma.-% ¹⁾	≤0,7
ash softening temperature	(DT) °C	≥1200
chlorine content	Ma.-% ¹⁾	≤0,02
sulphur content	Ma.-% ¹⁾	≤0,03
nitrogen content	Ma.-% ¹⁾	≤0,3
copper content	mg/kg ¹⁾	≤10
chrome content	mg/kg ¹⁾	≤10
arsenic content	mg/kg ¹⁾	≤1
cadmium content	mg/kg ¹⁾	≤0,5
mercury content	mg/kg ¹⁾	≤0,1
lead content	mg/kg ¹⁾	≤10
nickel content	mg/kg ¹⁾	≤10
zinc content	mg/kg ¹⁾	≤100

1) in an anhydrous state

2) diameter must be specified

3) a maximum of 1% of the pellets may be longer than 40 mm,
max. length is 45 mm

4) the limit value of ≥97,7 Ma.-% applies when conducting measurements with a
lignotester (internal control)

Note

Please ask your pellet stove dealer for tested fuel and a list of monitored fuel manufacturers.

Using poor quality or prohibited pellet fuel will have a negative effect on the function of your pellet stove and can also lead to the warranty becoming null and void, as well as the product liability connected with this. Observe waste incineration legislation!

Only burn pellets that have been inspected according to ÖNORM, DIN Plus or ENplus-A1.

Pellet storage

In order to guarantee problem free burning of the wooden pellets, it is imperative necessary to store the fuel as dry as possible and free from impurities.

Pellets should not be kept in sacks outdoors or stored in a manner where they are exposed to the environment. This can lead to blockages in the screw conveyor

Note

“screw stoppers” are excluded from the warranty.

Note

Your pellet stove is only approved for the burning of wood or pellets of tested quality. Burning straw, maize, woodchips etc. is not permitted! Non-observance of these regulations makes void all warranty and guarantee claims and may impair the safety of the unit!

4. TECHNOLOGY AND SAFETY FUNCTIONS

The technological advances in your new combi stove are the result of years of testing and practical experience. The practical advantages of your pellet stove are convincing:

Operating comfort

The microprocessor-controlled combustion regulation optimises the interaction of flue gas blower and screw using the current combustion chamber temperature. This guarantees optimum combustion and operating status.

All function can be regulated centrally using the integrated operating unit. The intuitive graphic interface permits easy operation; all the settings can be made quickly and simply.

Top efficiency – lowest emissions

A very great heat exchange surface together with optimum combustion air control leads to excellent fuel utilisation.

Fine continuous pellet dosing in an optimised burner pot made of high-quality grey cast iron leads to virtually complete combustion with very good exhaust gas values - and this is guaranteed in every operating phase.

Note

The automatic control system means that during operation, the flame noise, pellets dropping and actuation of the electronic components permissible for living spaces are audible.

Pressure monitoring

The negative pressure in the combustion chamber is continuously monitored during operation. Below a defined threshold, a correct operation can not be guaranteed and the unit will switch off with the fault message „vacuum control“ for safety reason.

Note

After the occurrence of the error message, maintenance or cleaning work necessarily has to be carried out! If the error occurs again, a safe operation is no longer guaranteed, the service must be informed immediately.

Note

If the stove is used in a room together with a kitchen hood it might happen that the built-in pressure switch stops the stove. If using the hood make sure make sure that an adequate supply of air is ensured.

Overheating

A safety temperature limiter (STL) switches the stove off automatically on overheating. Once the stove has cooled, the STB at the stove rear must be unlocked manually (pressed). The stove is ready for operation again after acknowledging the error message at the internal unit.

Note

Maintenance and cleaning work must be performed if overheating occurs! If this error recurs, operation without danger is no longer guaranteed; notify customer service immediately.

Low-temperature shutdown

The unit switches off if the stove cools below a minimum temperature. This switch-off may occur if pellet ignition is delayed.

Electrical excess current protection

The stove has a main fuse (at the rear) to protect against excess current

Component monitoring

All the electrical components used are continuously monitored during operation. If a component is defective or can no longer be actuated correctly, then operation is stopped and a warning or error message is issued (see WARNING AND ERROR MESSAGES).

Power failure (during heating)

After a brief power failure, the operating functions that were set before the power failure, continues. If the power failure lasts longer, the stove goes to start phase if sufficient temperature or embers are present. If the power failure lasts too long, the stove goes into the stop phase. The flue gas fan continues to burn any pellet residues (approximately 10 minutes). Then it will restart automatically.

Power failure (during the initial stage)

After a brief power failure the boot process continues. If the power failure lasts longer, the stove is in the stop phase. The flue gas fan continues to burn any pellet residues (approximately 10 minutes). Then it will restart automatically.

5. INSTALLING THE STOVE

General information

The smoke extraction system is based on negative pressure in the combustion chamber and a slight excess pressure in the flue gas outlet. Therefore it is important that the flue connection is installed correctly and airtight

Note
Only use heat-resistant sealing materials as well as corresponding sealing strips, heat-resistant silicon and rock wool.

Note
Assembly may only be performed by authorised specialist companies.

Note
Also take care that the flue does not project into the free cross-section of the chimney.

Note
Please observe the regional safety and building regulations. Please contact your master chimney sweep in this context.

Avoid flue pipes to the stove being too long. The horizontal length of an exhaust line should not exceed 1.5m.

Avoid frequent changes in direction of the exhaust gas flow to the chimney.

There should be a maximum of 3 bends in the exhaust line.

If you cannot connect directly straight to the chimney, use a connection with a cleaning opening if possible.

Note
Your stove is intended for room-air independent operation. Thus the stove pipe connections must be tightly sealed permanently for this use. Use a heat-proof silicon to position the stove pipe on the conical supports of the flue tube nozzles and for insertion in the chimney flue lining.

Note
The stove should not be pushed on unprotected floors.

Tip
Strong corrugated cardboard, cardboard or e.g. old carpet is useful to assist assembly and as a base. The stove can also be pushed on this cardboard or carpet.

We recommend original flue pipes from RIKÄ for proper connection.

Combustion air

Every combustion process requires oxygen from the surrounding air. This so-called combustion air is removed from the living area in the case of individual stoves without external air connections.

This air removed must be replaced in the living space. Very tightly sealed windows and doors in modern flats may mean that too little air replaces that used. The situation also becomes problematical due to additional venting in flats (e.g. in the kitchen or WC). If you cannot feed in external combustion air, then air the room several times a day to prevent negative pressure in the room or poor combustion

Note
Please note that problems may arise due to updrafts in the case of combustion air supply from an integrated chimney ventilation shaft. If the combustion air flowing downwards is heated it may rise and thus counter the chimney with a resistance which in turn reduces the negative pressure in the combustion chamber. The chimney manufacturer is to guarantee that the resistance for the combustion air is a maximum 2 Pa even in the least favourable operating state of the chimney

Feeding in external combustion air

only for devices which are able to run in room-air independent operation.

- Combustion air must be fed to the stove from outside via a sealed pipe for operation independent of the room air. According to EnEV, it must be possible to shut off the combustion air pipe. The open/closed setting must be clearly recognisable.
- Cut the perforated right rear wall out with a hacksaw.
- Connect to the intake nozzle either a pipe Ø125mm (logs stove and combi stove) or Ø50mm (pellet stove) and fix this with a pipe clamp (not included in scope of supply!) On pellet stoves with longer connection pipes, the diameter should be enlarged to some Ø100mm after approx. 1m.
- To ensure sufficient air intake, the line should not be longer than 4m and should not have too many bends.
- If the line leads outside it must have a windbreak.
- In extreme cold pay attention to icing of the air intake opening (check).
- It is also possible to suction in combustion air directly from another sufficiently vented room (e.g. cellar).
- The combustion air pipe must be tightly connected (adhesive or cement) permanently to the air nozzles of the stove.
- If you do not use the stove for a long time, please close the combustion air intake to prevent the stove from moisture.

If one or more of these conditions does NOT apply, the result is poor combustion in the stove and negative pressure in the installation room.

Convection air conduction

The stove is delivered with a cover on the convection air outlet to prevent direct heat to the wall.

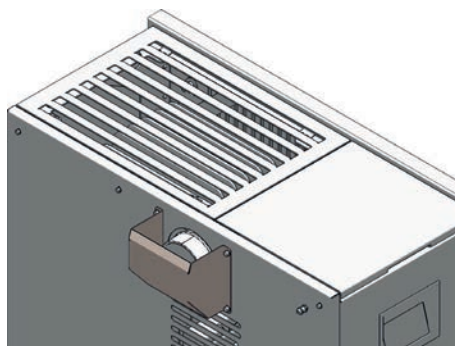

Operation without this cover or without attached convection pipes is not allowed. If you do though no warranty and no liability is accepted for damage.

- The amount of air and temperature is designed to heat one additional room.
- Note the regional specific fire safety regulations and clarify the connection situation with the competent authority
- The max. temperature of the convection air is 180° C at the air outlet.
- The convection air should be as short as possible.
- Keep the number of deflections as small as possible.

Note
Please pay attention to the national and country-specific building and fire regulations when connecting the convection air pipes. Installation and assembly must be performed by a trained specialist only.

6. ASSEMBLY/DISMANTLING STONE AND OPTIONS

Note
Only work on the unit when the mains plug has been disconnected and the stove has cooled completely.

Note
During assembly / dismantling do not allow objects (screws etc.) to fall into the pellet container – they can block the screw conveyor and damage the stove.

Note
During any conversion work, take particular care of your fingers and any panels and stove attachments.
Select soft bases to prevent scratches to your living space furniture and stove panels.

Dismantling stone

Loosen the 4 Allen screws and slide the confection fins to the right.

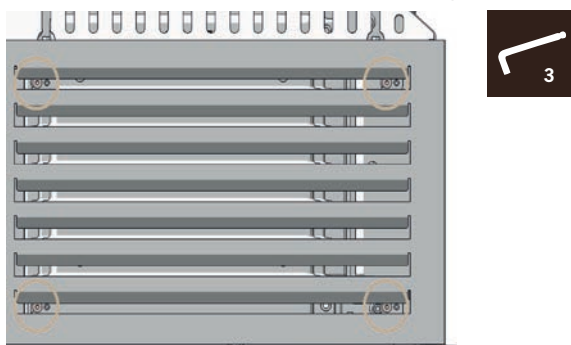

You can pick up the confection fins now.

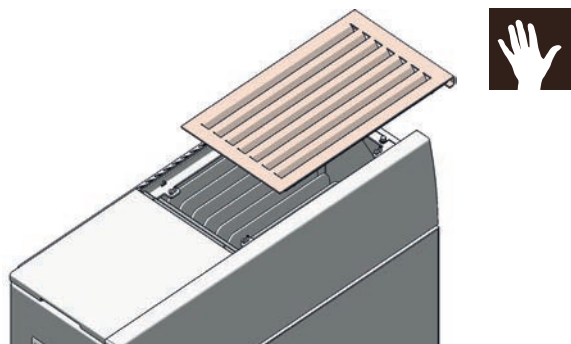

Open the pellet container lid until it stops, in this position, it stays open.

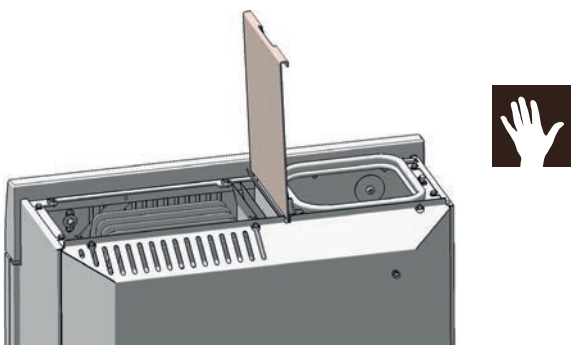

Remove the self-locking hex nut including the cover plate which is used to seal the pellet hopper.

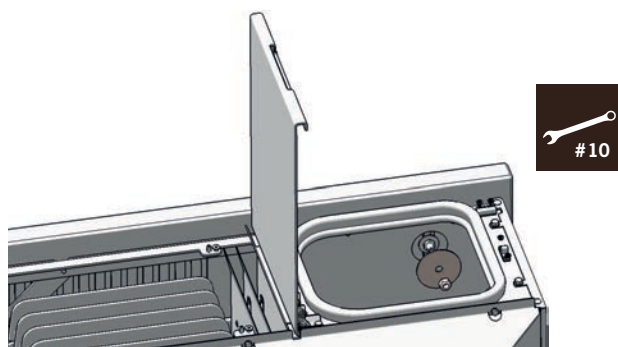

Remove the two hex nuts including washers.

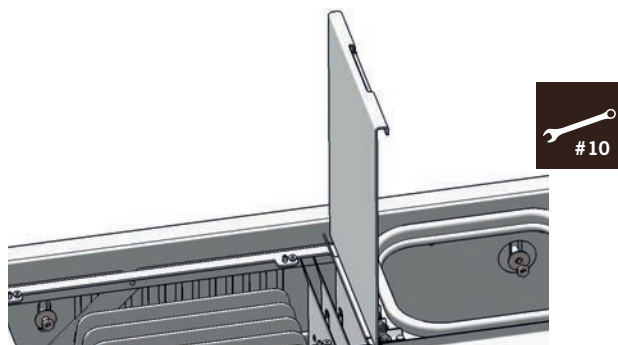

Now you can lift off the top stone to the front.

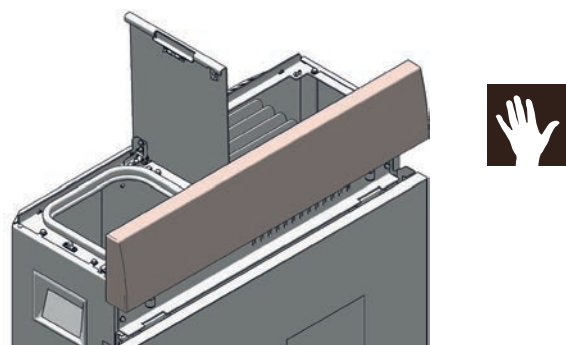

The side metal casing is secured with 2 hex screws. Remove these and lift the side panels up and away.

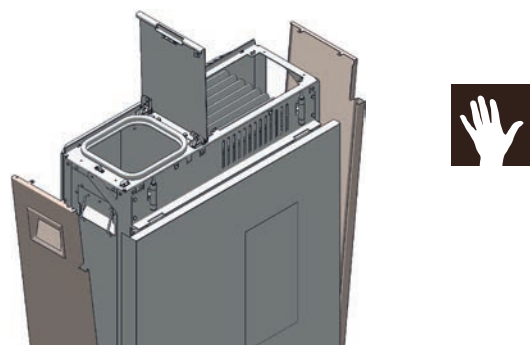
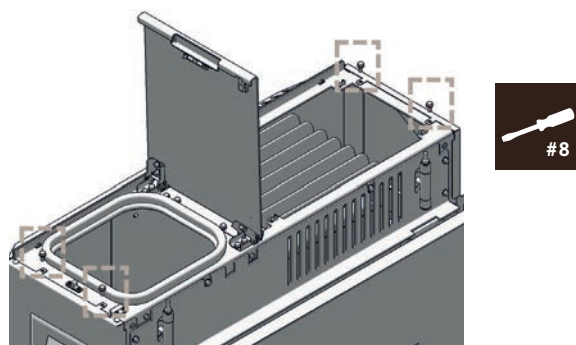

Now you can remove the two bottom hex nuts including washers.

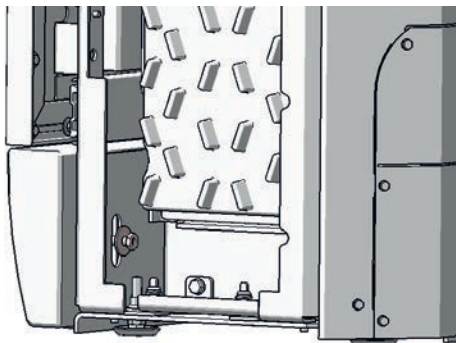
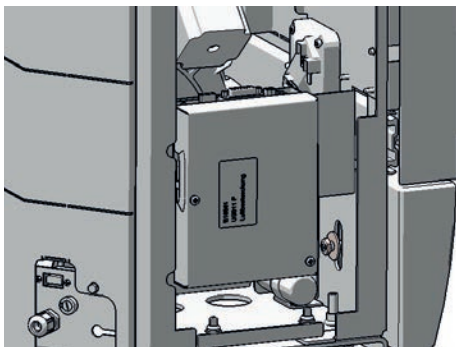

You can now lift off the bottom stone forward.

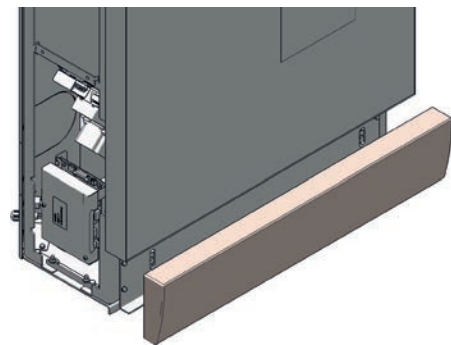

Mount the removed parts in reverse order.

7. INTERNAL CONTROLS – TOUCH-DISPLAY

The stove has a modern programmable microprocessor control. The individual stove functions can be set by the user via the touch display.

Note
Manipulation of hardware components may only be performed by trained specialist dealers and service. Incorrect handling of these parts leads to loss of warranty and guarantee claims!

Basics

All settings and functions can be made via the integrated touch screen. Actions are initiated by touching the symbolic buttons. The touch display reacts to both finger touch and touch display pen

Note
Please do not use any sharp objects to prevent damage to the touch display.

Operation

Each input button has the status inactive, active and depressed. If an input button on the display is greyed-out, i.e. inactive, then it only reserves space and cannot be selected. This is the case if no response can be expected from pressing this input button (e.g. increasing the heat output if it is already at 100%; switching on if the stove is already switched on, ...)

Active input buttons can be pressed at any time, in confirmation the status changes to depressed; this status is retained as long as the button is pressed. After pressing the input button, the status returns to active or inactive.



active



depressed



inactive

Input possibilities



OFF-Button
Pressing the OFF button switches off the section concerned.



ON-Button
Pressing the ON button switches on the section concerned.

Note
The stove is switched ON or OFF in the HOME main menu. The respective button must be depressed for 2 seconds to prevent inadvertent switching on or off.



MINUS-Button
Pressing the MINUS button reduces the value in the display box concerned.



PLUS-Button
Pressing the PLUS button increases the value in the display box concerned.



NAVIGATION-Button
Pressing the NAVIGATION button takes the user to the corresponding main menu.



INPUT-BOX
There is an input box for input of a multi-digit, numerical value.



NUMERICAL
A number pad appears for input of a multi-digit, numerical value.



ENTER-Button
The input value is confirmed by pressing the ENTER button.



CANCEL-Button
The value displayed is deleted by pressing the CANCEL button.



SUBMENU-Button
Pressing the SUBMENU button takes the user to the corresponding submenu.



ACTIVE-Button
The option shown is selected by pressing the ACTIVE button.

Displays



INFO-box
This box provides information via the adjacent value in the display box.



DISPLAY box (ON/OFF)
A display box with ON or OFF is shown for options that can be switched ON or OFF.



DISPLAY box (numerical)
A number is shown for values represented numerically.

Putting into operation

Note
The unit may only be put into operation when assembled completely!

The USB stick supplied must be plugged into the interface on the rear of the stove before the unit can be taken into service for the first time.

USB Connection



A start screen appears after connection to the mains supply. The language selected is changed by pressing respective language button on the screen.

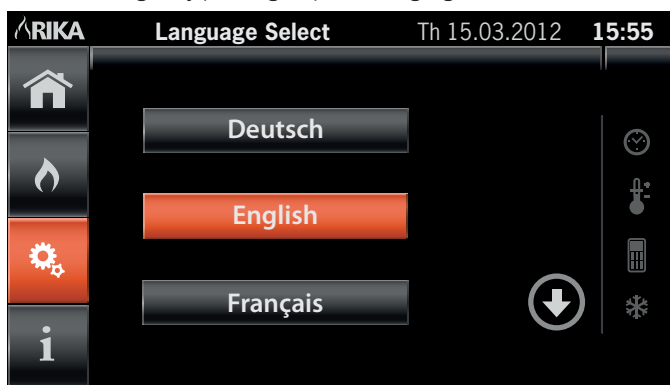

The software is automatically updated after language selection. This process takes approx. 2 min.

Note
Während des Software-Updates ist eine Unterbrechung der Stromversorgung unbedingt zu vermeiden. Hard

A confirmation display appears after successful software update; the stove must be disconnected from the mains and the USB stick removed

First steps

Once the stove has been reconnected to the mains, the display changes to the date and time setting by pressing the screen.

The input specified here only has to be made on first use; however it may be changed at any time in the main menu SETUP settings.

The date and time setting is made numerically using the number pad.

Tip
Only the permissible numbers are released for each input step to prevent incorrect input.

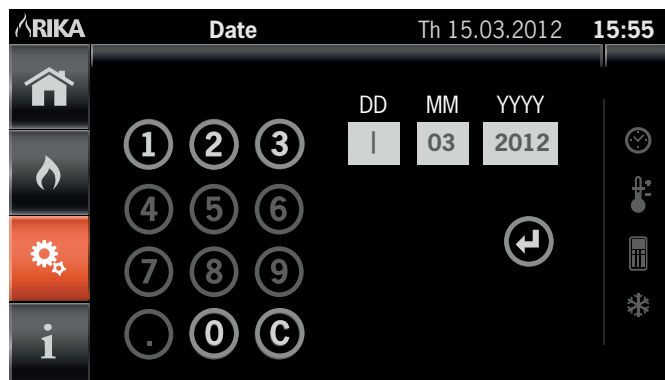

The C button acts as back button and deletes the input in the display box selected.

Tip
The individual input boxes are selected by touching the display boxes and the content is reset by direct selection.

Once all data has been entered correctly, an ENTER button appears which confirms the input and saves the data.

HOME – main menu

The HOME main menu is the starting point of the stove control system and is divided into three sections.

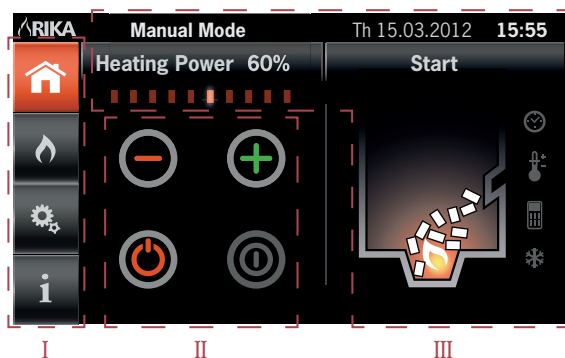

I NAVIGATION SECTION

Navigation among the individual main menu levels.

Tip
The current main menu is marked in colour to ease navigation.



II SETTINGS SECTION

Setting the heat output and the room temperature as well as ON and OFF switch for stove.

III DISPLAY SECTION

Display of the current date and time, operating status and mode as well as additional information symbols.

Main menu levels

The complete control system of the stove is divided into 4 main menu levels (HOME, MODE, SETUP und INFO; these levels are differentiated based on the following functions:



HOME-status level

Stove start/stop, setting heat output, room set temperature, current stove status display



MODE-operating mode level

Selection of the required operating mode (manual, automatic, comfort)



SETUP-setting level

Setting of heating times, settings for various options, ...



INFO-information level

Software version, pellet consumption, hours in operation, information on the individual components,...

MODE – mode selection

The various heating modes are selected in this display.

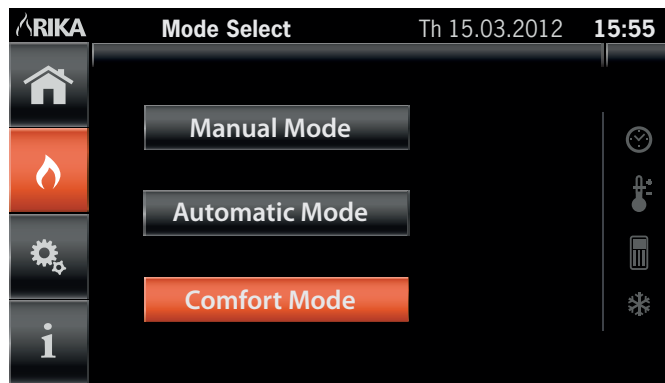

Manual mode

The stove is operated at a pre-set heat output.

Automatic mode

Individual heating times may be activated in addition to the pre-set heat output.

Comfort mode

Regulation to the pre-set room temperature is automatic in this selection. Heating times may also be activated.

Note

The comfort mode can only be selected if a functioning room sensor is connected



SETUP – settings

In the SETUP – Settings main menu, heating times can be programmed, options activated or then date and time set etc.

The required submenu is selected by pressing the corresponding button

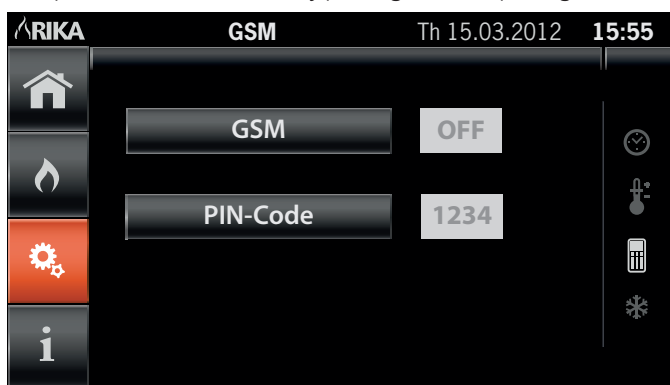

Note

If functions are inactive due to lack of the respective module, they cannot be selected.

SUBMENU ITEMS

Heating times

The ON and OFF switching times can be programmed in this submenu. A decreasing temperature for the comfort mode can also be set.

Room sensor

Any deviation between the current displayed and actual room temperature can be compensated for.

GSM

If a modem is connected, the stove GSM function can be activated and the PinCode required entered numerically.

Frost protection

This function allows selection of a minimum temperature at which the stove starts to heat. The frost protection function is independent of any external requirements and any set room temperatures. The function has top priority.

Transverse current blower

The optional transverse current blower can be activated in this submenu.

Child safety device

To prevent undesired operation, a code can be determined to be entered every time the screen saver is left.

Date/time

Date and time settings can be made.

Screen saver

The waiting interval until the screen saver is activated is set in this submenu.

USB update

This menu level concerns the software update of the stove.

Service (not accessible to final customers)

Additional information for the specialist dealer or service.

Heating time programme

The heating time programme operates the stove time-controlled. As soon as the heating time function has been activated (ON) the buttons decreasing temperature (only with room sensor) and heating time programme can be selected.

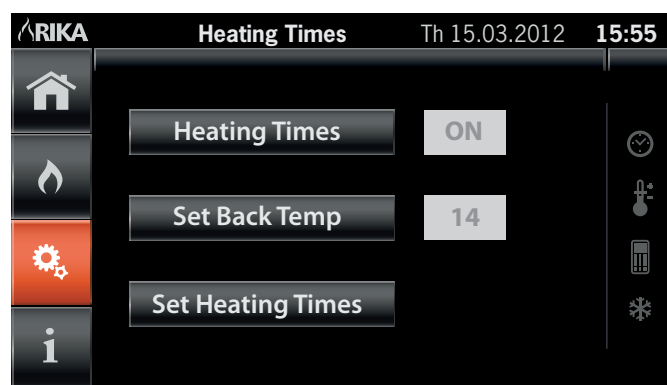

Individual or several days can be selected at the same time and programmed individually in the heating time programme.

The week days selected are marked **ORANGE**.

By selecting the now active heating time buttons (heating time I and heating time II), the required ON and OFF switching times can be entered numerically.

The week day buttons are shown **GREEN** after confirmation.

Repeat pressing of week day buttons already programmed permit viewing of the defined heating times or these can be deleted again using the cancel button (right next to the time displayed).

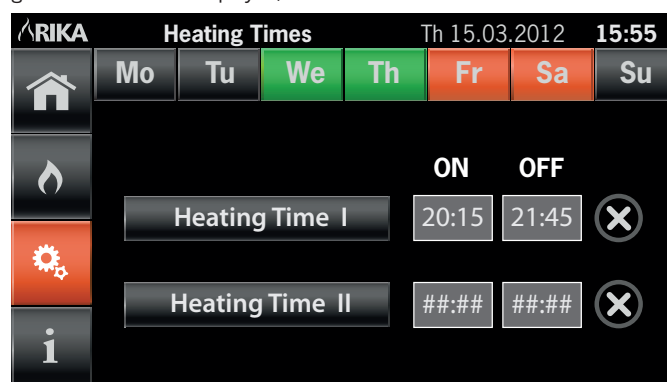

Tip

In the case of selected week days on which identical heating times have been programmed, the respective settings of heating time I and/or heating time II are shown.

If week days with different heating times have been selected then the hash symbol appears in the time display (##:##).

INFO – main menu

The most important current parameters can be viewed in INFO – main menu.

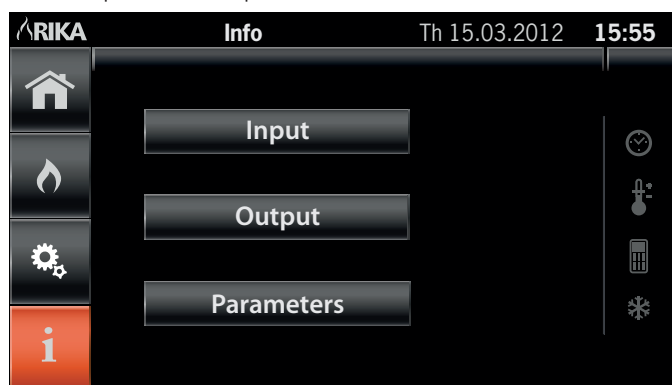

SUBMENU ITEMS

Inputs

All available sensor data and switch statuses are shown.

Outputs

All components controlled by the microprocessor are shown.

Parameters

All operating parameters are shown

INFO – inputs

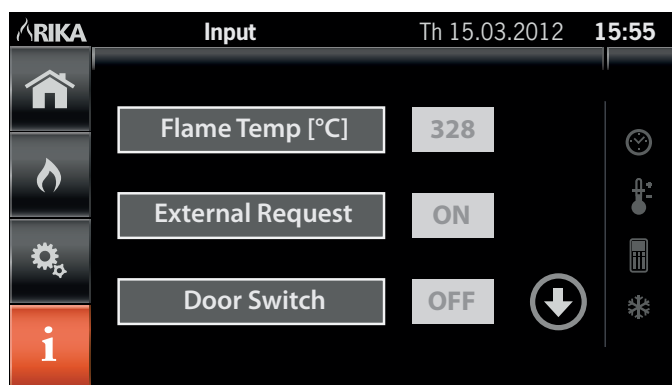

Flame temperature

Display of the current temperature of the combustion chamber [°C]

Room temperature

Display of the current ACTUAL temperature in the room [°C](only with connected room sensor)

Ext. demand

Displays whether an external demand is active (ON) or inactive (OFF).

Dump grate contact

Displays whether the dump grate is in the horizontal position (ON).

Door contact switch

Shows whether the combustion chamber door is closed (ON) or open (OFF).

Container lid

Shows whether the pellet container lid is closed (ON) or open (OFF).

INFO – outputs

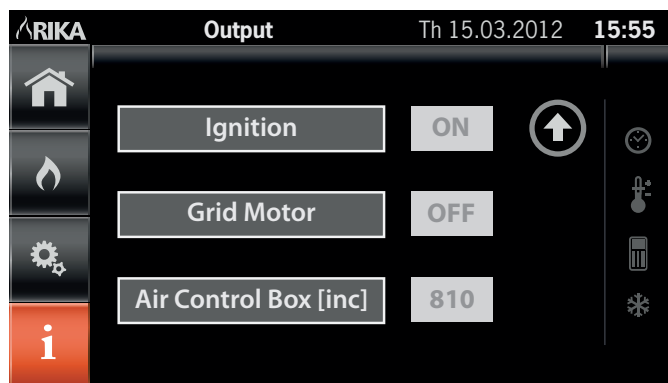

Discharge motor

Current speed of screw motor conveying away from the pellet container (range: 0...1000)

Feed motor

Current speed of screw motor conveying to the fire trough (range: 0...1000)

Flue gas blower

Current speed of flue gas blower. (Range: 0...2500)

Ignition element

Shows whether the ignition is switched on (ON) or switched off (OFF).

Dump grate motor

Shows whether the dump grate motor is actuated (ON) or not (OFF).

Air controller

Current air flap position (range: 0...1000)

INFO – parameters

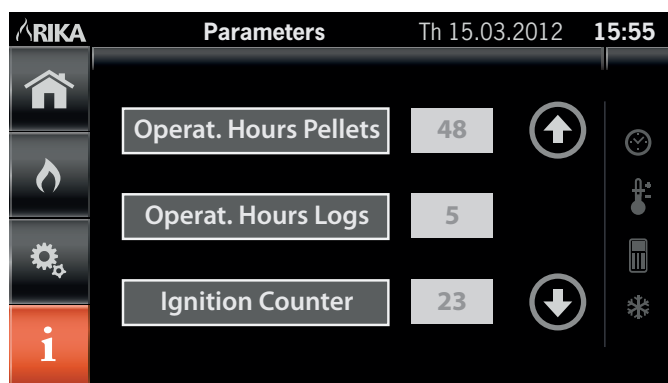

Hours in operation

Display of previous total operating hours.

Conveying total

Display of total pellet amount supplied up to present.

Conveyor cleaning

Display of the amount of pellets to be conveyed until the next cleaning.

Ignitions

Current number of all previous pellet ignitions.

Software stove

Current stove control software version.

Software display

Current software version of the touch display.

Main state

Operating status of main control process.

Sub state

Operating status of sub control process.

Screen saver

Depending on the interval set without touching the display, the lighting is dimmed and power-saving mode is activated, a freeze image appears.

Renewed touching of the display activates the lighting and switches to the HOME main menu



Tip

The interval to activation of the power-saving mode can be set under Setup – screen saver.

Additional information

In nearly all the menu levels there are four symbols in the right outer display area showing the activated settings



HEATING TIMES

This symbol is highlighted if individual heating times are activated.



ROOM SENSOR

This symbol is highlighted if a functioning room sensor is connected.



FROST PROTECTION

This symbol is highlighted if the integrated frost protection is activated.



Note

The frost protection function can only be activated with connected room sensor. If activated, it is executed in all operating modes (also in MANUAL and AUTOMATIC).



GSM

This symbol is highlighted if a functioning GSM module has been connected and activated.



Note

The additional information symbols can only be highlighted if the corresponding modules have been connected to the stove and activated.

8. COMFORT OPTIONS

We would point out that auxiliary units may only be connected to the RIKA interface connection and external connection socket by authorised specialists.

RIKA room sensor/RIKA radio room sensor

This option permits control of your stove via room temperature. You can set both the room temperature and the heating times required. A room temperature selected by you is observed during the heating times.

Please see the operating instructions for the option RIKA room sensor and wireless room sensor for more detailed information.

RIKA GSM Control

Your stove can also be controlled via a mobile phone as an additional option.

Please see the operating instructions for the telephone option – GSM for more detailed information.

RIKA interface for various options

for various options

The RIKA ROOM SENSOR, the RIKA WIRELESS ROOM SENSOR and the RIKA PHONE OPTION – GSM are to be connected to the interface (stove rear) using the connection cable supplied.

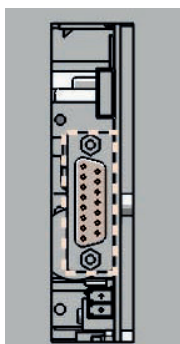

External room thermostat

Your stove has an interface on the rear wall to which you can connect a customary room thermostat. This requires a 2-pole cable of 0.5 – 0.75 mm² cross-section that you have to connect instead of the cable bridge fitted for delivery

External connection cable bridge

(condition as delivered)

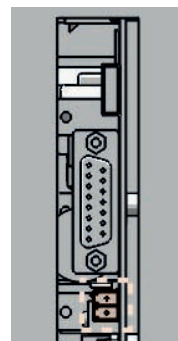

If the control of your stove is to be assumed by an external room thermostat, you have to connect your external room thermostat (1) instead of the standard integrated cable bridge (2).

The connected room thermostat can be operated in either MANUAL or AUTOMATIC MODE. In both MODES, the current set heat output is used, in AUTOMATIC MODE the heating times set at the stove can also be activated.

You can see whether the external demand is currently activated in the INFO main menu in submenu item Info - inputs.

If your stove receives an external demand to stop operation, it takes approx. 5 minutes until it switches off. All further settings required to your thermostat can be taken from the respective room thermostat operating instructions.

Note

Operation is not possible unless either a cable bridge or an external room thermostat is connected. The external demand has priority over all operating modes (MANUAL/AUTOMATIC/COMFORT).

9. MODES

Note

When operating correctly, the stove may not be overheated. However Improper operation can shorten the life expectancy of electrical components (blowers, motors and electrical control) and is not allowed!



Pellet operation manual/automatic/comfort

MANUAL MODE

The pellet burner start and stop (ON / OFF button) and set the desired heat output (PLUS / MINUS button) can be done on the touch screen directly at the HOME main menu.

AUTOMATIC MODE

The exchange between standby and hibernation (ON / OFF button) and set the desired heat output (PLUS / MINUS button) can be done on the touch screen directly at the HOME main menu.

In AUTO mode, the heating times can be activated and the heating times can be programmed.

The pellet burner start is in standby mode (ON) within the heating times (or always at deactivated heating times).

The pellet burner stop is outside the heating times.

In the hibernation (OFF) no pellet burner start is possible, the system is turned off.

COMFORT MODE

The exchange between standby and hibernation (ON / OFF button) and set the desired room temperature (PLUS / MINUS button) can be done on the touch screen directly at the HOME main menu.

In the COMFORT mode heating times can be additionally activated.

The pellet burner start is in standby mode (ON) within the heating times (or always at deactivated heating times) and if the desired room temperature is below the actual room temperature.

The pellet burner stop either outside the heating periods, or if the desired room temperature is higher than the actual room temperature.

In the hibernation (OFF) no pellet burner start is possible, the system is turned off.

Convection fan control Manual / Automatic

MANUAL MODE

In manual mode, you can turn on the convection fan to a desired air level, level 1 (minimum) - Set level 5 (max).

AUTOMATIC MODE

In automatic mode, the convection fan level is depending on the heating power (30 - 100%) automatically adjusted.

Tip

You can additionally adjust the amount of air in the setup menu (+ / - 30%). This applies to manual and automatic mode.



Pellet container refilling

Note

CAUTION when filling! Don't allow the pellet bag to get in contact with the hot stove. Remove immediately pellets which have not found their way into the reservoir!



In order to prevent the fire from extinguishing due to a lack of pellets, we recommend to keep an appropriate level in the reservoir upright. A 15 kg bag of pellets can be filled into your stove when half of the pellets the pellet container was consumed. See the level frequently. The container lid must, however, always be kept closed except when filling.

When filling the container during operation (opening the container lid) the fan starts up and pellet transport stops immediately, the operation will be resumed after closing the container lid (see WARNINGS AND ERROR MESSAGES)

Pellet container capacity (see SPECIFICATIONS).

Emergency operation - heating up without electrical Ignition

If the ignition cartridge fail, firelighters can be used for an emergency operation. First, start the stove as usual. Wait for the turning of the grid (only for units with turning grids). Then open the combustion chamber door and give a handful of pellets with the igniter into the cleaned burn pot, light up this and close the combustion chamber door.

Note

: Do not use flammable liquids to light up the fire!



10. WARNING AND ERROR MESSAGES

During operation, unforeseen circumstances or intervention by the user may lead to malfunctions or interruptions of the control process. There is a differentiation between warnings and error messages. Warnings are interruptions caused by the user; they can be eliminated by correct actions. Error messages are malfunctions of components or discharges during operation. These must be acknowledged by the user so that operation can continue.

Note
If error messages recur directly, customer service is to be notified immediately. In the case of error messages that pose a safety risk, burnback and flue gas flap is activated and the stove is automatically switched off.

EN

Warnings

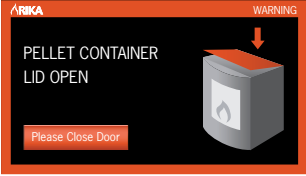
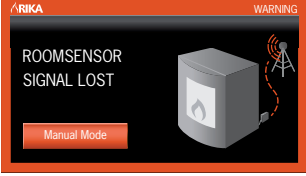
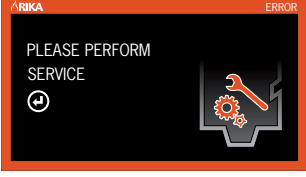
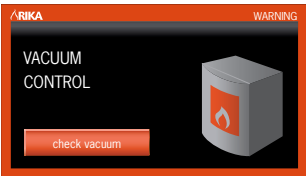
display	meaning	action to be taken
	Display for open combustion chamber door and/or pellet container lid.	Close the combustion chamber door and/or the pellet container lid.
	There is no valid signal between the stove control system and the room sensor.	Verify if the wireless room sensor is connected properly. Check the light of the receiver and change the batteries in the transmitter if necessary.
	Perform service (maintenance)	Perform service (see CLEANING AND MAINTENANCE)
	The negative pressure in the combustion chamber is below a defined limit value.	Check that the combustion chamber door is closed.

Errors

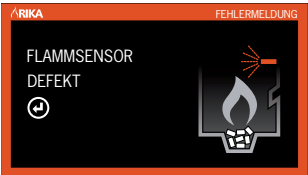
display	meaning	action to be taken
	There are no longer sufficient pellets in the container.	Acknowledge error message and refill pellets.
	Ignition cannot be concluded due to lack of ignition detection.	Acknowledge error message and check pellet supply container. Open combustion chamber door and clean fire trough if necessary. Stove can then be restarted.
	The dump grate cannot complete the dump process provided for.	Acknowledge error message and check for any blockage of the dump grate at the fire trough.
	One of the two screw motors for pellet conveying can no longer be actuated.	Acknowledge error message and restart stove.
	The flame temperature sensor in the combustion chamber does not give a realistic temperature to the stove control system.	Acknowledge error message and restart stove.
	The flue gas blower specified speed was not reached.	Acknowledge error message and restart stove.
	The conveyor can not be controlled correctly.	Acknowledge error message and restart stove.
	The negative pressure in the combustion chamber is permanently below a defined threshold.	Acknowledge the error message and check the stove for possible leaks. (combustion chamber door, cleaning lid, etc.)

11. CLEANING AND MAINTENANCE

Basic information

Note

Your stove must be switched off and cooled before any maintenance work is performed. Ensure that you do not vacuum into the combustion air line during heating operation during any cleaning (vacuuming). You could vacuum out embers – FIRE RISK!

Note

SERVICE appears in the display after consumption of 700 kg pellets. Cleaning and maintenance is to be performed. This message can be acknowledged by pressing ENTER and operation can be continued. The number of SERVICE messages is stored in the background.

Note

Only work on the unit when the mains plug has been disconnected.

The frequency with which the stove requires cleaning and the maintenance intervals depend on the fuel you use. High moisture content, ash, dust and chips may more than double the maintenance required. We would like to again point out that only tested and recommended pellets or logs may be used as fuel.

Tip

wood as fertiliser - The mineral content of the wood remains in the combustion chamber as ash as a residue of the combustion. This is an excellent fertiliser for all plants in the garden; it is a completely natural product. The ash should be stored first and extinguished with water.

Note

Ash may contain embers – only place ash in sheet steel containers.

Cleaning the fire trough

Despite the automatic ash dumping prior to and during heating operation, care should be taken that the air intake openings are not blocked with ash or clinker. Remove the clinker using the wire brush supplied and vacuum out the fire trough.



Note

Clean the fire trough regularly. Only clean when cold, when embers are extinguished!

Empty the ash drawer

Empty the ash drawer regularly. The ash drawer is simply pulled forward with the combustion chamber door open.

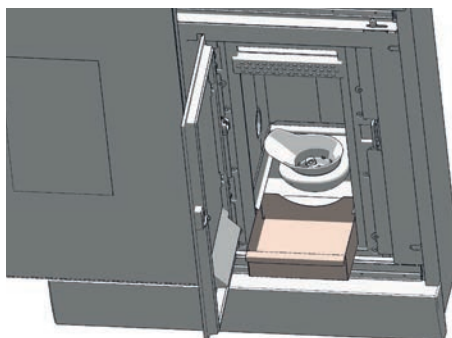

Cleaning the door glass

The viewing window becomes coated in the case of solid fuels, particularly with the very fine ash of wood pellets, light or dark depending on the pellet quality (especially with low output). The glass can be cleaned best with a moist cloth. Stubborn dirt can be removed with a special cleaner available from your stove dealer.

Cleaning flue pipes

The flue pipes should be cleaned at least 2 x a year or after approx. 700 kg pellets. The flues are behind the combustion chamber.

Loosen the 4 Allen screws and slide the confection fins to the right.

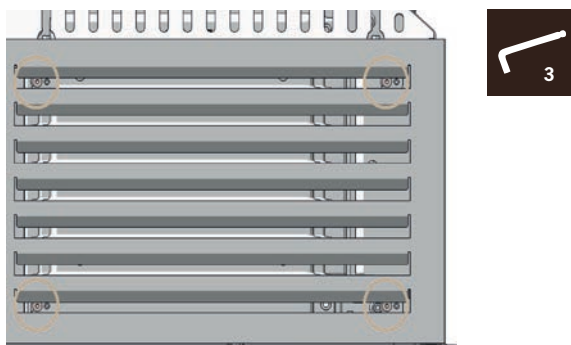

You can pick up the confection fins now.

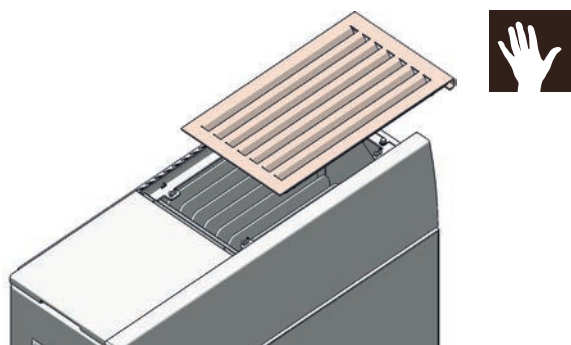

You can now remove the 4 screws of the combustion chamber lid, remove the lid and place it on a soft surface.

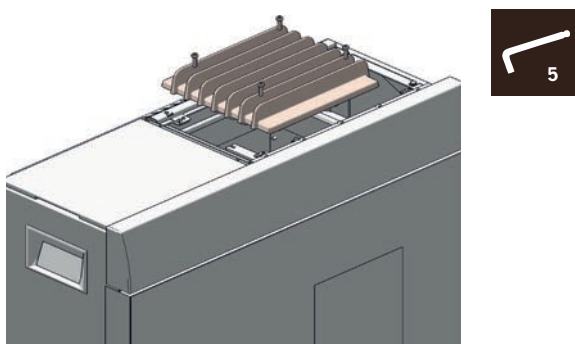

Open the two hex screws and remove the cleaning lid.

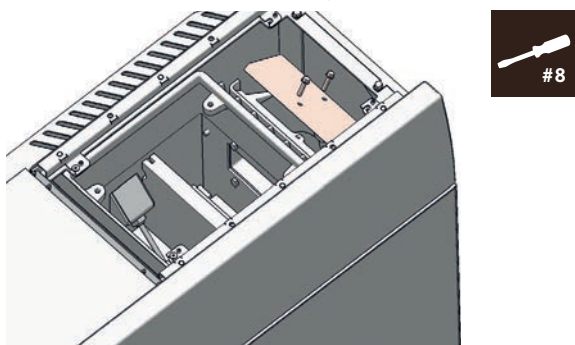

Now clean the flues with the included wire brush.

Suck the combustion residues out of the deflection region.

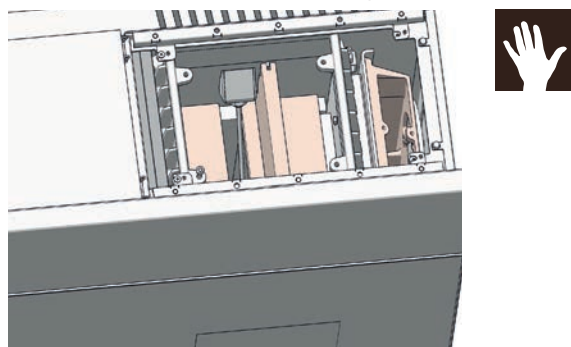

Remove the ash tray.

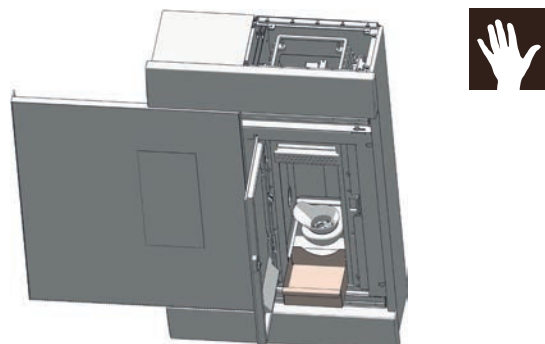

Open the 4 thumb screws and remove the cleaning lid.

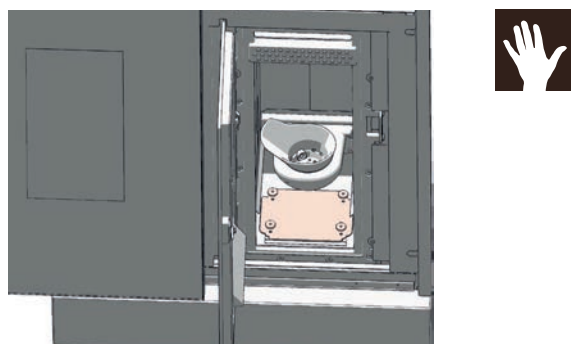

Suck the combustion residues out of the flue gas manifold. Especially the transition areas to the side flue gas channels (left and right).

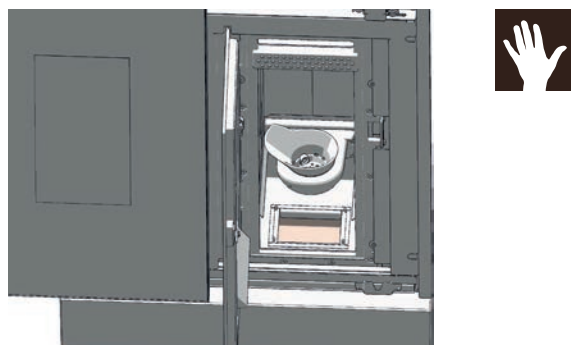

Mount the removed parts in reverse order.

Note

Your stove may suck in false air via incorrectly sealed cleaning covers; this air may lead to incomplete combustion in the fire trough and thus piling up of pellets.



Cleaning the flame temperature sensor

Remove the dust deposits from the sensor at regular intervals. Use a clean cleaning cloth or newspaper.

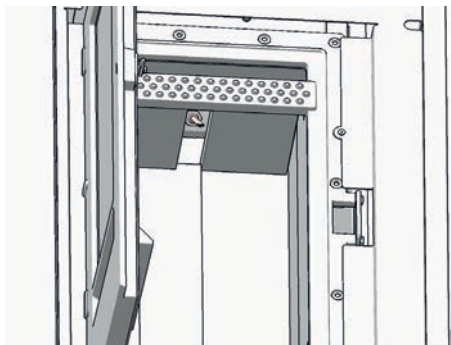

Checking door seal

The condition of the seals at doors and glass should be checked at least 1 x per year. Repair or replace seals depending on condition.

Checking chimney connection

Inspect and clean connection. Accumulated fly ash may impair the performance of the stove and pose a safety risk.

Cleaning the pellet container

Do not refill the completely empty container immediately; remove the residues (dust, chippings etc.) from the empty container. The unit must be disconnected from the mains!

12. PROBLEMS - POSSIBLE SOLUTIONS

Problem 1

Fire burns with weak, orange flame. Pellets heap up in fire trough, window sooted up.

Cause(s)

- Insufficient combustion air
- Poor chimney draught
- Stove is sooted over inside

Possible solutions

- Remove any ash or clinker from the fire trough that may block the air inlets. If possible swap to better pellet quality (see CLEANING AND MAINTENANCE)
- Check whether flue gas pipes are blocked with ash (see CLEANING AND MAINTENANCE).
- Check whether the suction nozzles and air inlet pipe or flue tube are blocked.
- Check door and cleaning cover seals for leaks (see CLEANING AND MAINTENANCE)
- Clean blower impeller (see CLEANING AND MAINTENANCE)
- Have service performed by authorised specialist company.

Problem 2

Stove smells strongly and smokes outside.

Cause(s)

- Burning-in phase (taking into service)
- Stove has accumulated dust and/or dirt

Possible solutions

- Wait to end of burning-in phase and vent sufficiently
- Suction off any dust deposits from the convection air openings at regular intervals

Problem 3

Flue gas discharge when wood is added and during heating phase.

Cause(s)

- Inspection openings leak
- Chimney draught too low
- Flue pipe connection leaks

Possible solutions

- Check seals and replace (fire door, plaster cover, ..)
- Check chimney
- Check connections and if necessary re-seal

Note

Please note that checks on the control system and wiring may only be performed in unit switched dead. Any repairs may only be performed by trained specialists.

Tip

If a malfunction message occurs, the cause must first be remedied; the unit can be put back into operation by acknowledging the malfunction at the internal unit.

13. INSTRUCTIONS FOR COMMISSIONING PROTOCOL

FOR PELLET AND COMBI STOVES

The commissioning protocol is to be treated as a document and serves as the basis for the warranty and guarantee terms. It is to be completed entirely, in particular the stove data and addresses, the work to be performed is to be ticked off after completion. The signatories confirm with their signatures that all the items on the list have been concluded properly.

Note

Please return 1 completed protocol for putting into service to RIKA Innovative Ofentechnik GmbH, Müllerviertel 20, A-4563 Micheldorf.



Electrical periphery

It is important that the connection socket in the electrical periphery is earthed. The operability of any room thermostat present must be checked. The execution of commands is to be established by phoning in the case of a GSM modem.

Exhaust gas system

The exhaust line, stove and combustion air inlet are part of the combustion system as a whole; therefore the correct execution must also be checked. The plug connections should be tight in general since the system works with excess pressure. The exhaust tube has a diameter of 150 mm which is sufficient for short distances. In the case of several changes in direction, the resistance of the exhaust system can increase with the flue to such an extent that the combustion quality suffers and/or noises arise from the greater flow speed. Correct determination of the chimney draught can only be performed at nominal thermal output and serves to evaluate the chimney. If the draught is more than 15 Pa, then a draught limiter should be installed.

Stove functions

These are the basic stove functions that are to be checked and ticked off. The stove is ready for operation if these functions are ensured.

Operator instruction

This is one of the most important points in the putting into operation. It is very important that the operator understands the stove properly and is prepared to assume responsibility for the basic tasks required for operational safety.

In particular the connection between special features of a biomass heating system and his obligations as well as the warranty and guarantee terms must be explained. e.g. non-tested pellets and screw blockers, lack of cleaning or maintenance and stove malfunctions. Thorough instruction can prevent many complaints.

Stove functions

Explanation of the processes in the stove during ignition, normal operation, cleaning phase etc.

Control

Explain operator's possibilities to intervene, empty pellet container, room thermostat, GSM modem, functions and settings, program times if necessary. Operating instructions: Handover and reference to the content to the following points, is a document.

Warranty terms

Difference between warranty (statutory) and guarantee (voluntary), terms of guarantee, determination of wearing parts, reference to pellet quality to be used and the consequences of poor quality.

Cleaning instructions

Ash and dust occurs with a biomass heating unit. The fire trough is to be cleaned regularly with regular heating operation (in the case of pellet operation, the drilled air holes in particular must be free of residues). The ash drawer is to be emptied regularly. The flue gas pipes are to be cleaned once or twice in the heating season depending on stove type; by a specialist company is best.

Maintenance

Maintenance work after defined burn-off output is to be performed by specialist company, including thorough cleaning.

Combustion

All doors must close tightly to prevent intake of false air.

Note

Please contact your warranty partner for any warranty questions or claims. This is your dealer or installation company. No warranty claims can be accepted without proper putting into operation, proper operation according to the operating instructions and the supplements in this information sheet.

**Protocol for putting into operation for RIKA pellet and combi stoves**

date: _____

Installation address	Dealer
Name: _____	Name: _____
Street: _____	Street: _____
City: _____	City: _____
Telephone: _____	Telephone: _____

Stove data

Stove type:		Casing undamaged	
Serial number:		Operating instructions	
Software version:		Warranty documents	
Touchdisplay version:		Door opener	

Electrical periphery

Connection socket earthed		GSM modem present	
Room thermostat present		Function checked	

Check of system components

Combustion chamber door seal checked		Ease of movement burnback flap checked (combi)	
Ease of movement flue gas flap checked (combi)			

Exhaust line / chimney

Diameter		Connection leakproof	
Bends		Chimney draught	

Stove functions

Pellet container filled		Grid turns (360°) und keeps in heating position	
Tested pellet quality according to Önorm/DIN plus/ENplus-A1		Ignition element glows	
Electrical connections made		Screw motors run	
Safety flaps tightened (combi)		Do pellets fall into the combustion chamber?	
Induced draught blower runs		Ignition performed	
Stove was switched off when handed over			

Operator instruction

Stove function		Warranty terms	
Control		Cleaning	
Operating instructions		Cleaning or maintenance interval	



work performed correctly according to order placed

Technician:

Operator

Client

Company: _____

14. GUARANTEE

These warranty conditions are only valid for the following countries: Austria, Germany and Switzerland. Separate conditions imposed by the importer apply for all other countries.

For the purpose of timely damage limitation, the warranty claim on the part of the claimant is to be enforced at the RIKA dealer in writing using the invoice and stating the purchase date, model name, serial number and reason for complaint.

WARRANTY

5 years on the welded stove body. This exclusively applies to defects in materials and workmanship as well as free replacement. Labour and travel times are not included in the manufacturer's warranty.

Only original parts supplied by the manufacturer should be used. Loss of warranty on non-observance!

The precondition for the warranty is that the stove has been installed and commissioned properly according to the User and installation manuals valid at the time of purchase. Connection must be performed by a specialist for such stoves.

Any costs incurred by the manufacturer due to unjustified warranty claims are to be charged to the claimant.

Wear parts and parts affected by fire are excluded, such as glass, coating, surface coatings (e.g. handles, panels), seals, fire trough, grates, draught plates, deflector plates, combustion chamber liners (e.g. fireclay), ceramics, natural stone, thermo stone, ignition elements, sensors, combustion chamber sensors and temperature controller.

Damage arising from non-observance of the manufacturer's instructions for operation of the unit or any damage that is caused by action such as overheating, use of non-approved fuels, tampering with the device or the flue gas pipe, electrical excess voltage, an incorrect, insufficient or excessive flue draught, condensation, non-performance or deficient maintenance and cleaning, non-observance of the relevant and applicable building regulations, incorrect operation by the user or third parties, transport and handling damage is also excluded.

THE WARRANTY DOES NOT AFFECT THE STATUTORY WARRANTY PROVISIONS.

01.07.2013



Technical and design changes, as well as typesetting and printing errors reserved

© 2014 | RIKA Innovative Ofentechnik GmbH

Art.Nr.: Z35344 | 05.03.2014



RIKA Innovative Ofentechnik GmbH
4563 Micheldorf/Austria, Müllerviertel 20
Telefon: +43 7582 686-41, Fax-DW: 43
E-Mail: verkauf@rika.at

RIKA.AT
